

February 9, 2024

ADDENDUM NO. 2

FOR

1269715: State/Lake Loop Elevated Station

SPECIFICATION NO. 1269715

RFQ # 9998,2

For which Bids are due in the office of the Chief Procurement Officer, Department of Procurement Services, <http://www.cityofchicago.org/eProcurement> at **11:00 a.m., Central Time on March 26, 2024.**

The following additions, changes and revisions are incorporated into the above-referenced Specification (the "Contract Documents") as noted. All other provisions and requirements as originally set forth, except as amended by previous addenda, remain in full force and are binding. Any additional work required by this Addendum shall conform to the applicable provisions of the original Contract Documents.

BIDDER MUST ACKNOWLEDGE RECEIPT OF THIS ADDENDUM IN THE SPACE PROVIDED ON THE PROPOSAL EXECUTION PAGE

NOTICE OF REVISIONS/CHANGES/CLARIFICATIONS

REVISION	DESCRIPTION
1.	The Bid Submittal Due Date has been extended to May 7, 2024, at 11:00 a.m.
2.	The presentation from the meeting on 2/1/2024 is attached as Attachment A.
3.	Sign in sheet for the meeting on 2/1/2024 is attached as Attachment B.

END OF ADDENDUM NO. 2

CITY OF CHICAGO
DEPARTMENT OF PROCUREMENT SERVICES

AILEEN VELAZQUEZ
CHIEF PROCUREMENT OFFICER

State and Lake Station

DPS Prebid Meeting

February 1, 2024



State/Lake Loop Elevated Station

Agenda

1. Existing Conditions
2. Project Objectives
3. Proposed Improvements
 - a. Elevated Station
 - b. Street/Sidewalk Level
 - c. Subway Layout
4. Construction Logistics
 - a. Schedule
 - b. Detours, Maintenance of Traffic, and Track Access
 - c. DCASE Artist Coordination
 - d. FTA SSC Process

←  Red Line trains



State/Lake Elevated CTA Line
NOT FOR DISTRIBUTION





Linden

Out to street, buses, and Red Line

Cottage Grove 14 min
2 min

Ashland/63rd
Cottage Grove

Out to street, buses, and Red Line

Midway

Danger - Keep Off Tracks High Voltage

6
Clear





State/Lake
cta Orange, Green to Ashland (3rd-Cottage Grove,
Purple and Pink Lines

State/Lake Elevated CTA Line
NOT FOR DISTRIBUTION

No Step-Free/ADA Access to Subway for Transfers







EXIT Lake-Randolph/State EXIT

Lake-Loop 'L'
One 10 block north
to State Lake station.
Free transfer (transfer required)

Orange Line

Green Line

Purple Line

Pink Line

Brown Line

Blue Line
Behind you

No accessible transfer to
Blue Line. Use Jackson St.

Lake-Loop 'L'
One 10 block north
to State Lake station.
Free transfer (transfer required)

Orange Line

Green Line

Purple Line

Pink Line

Brown Line

Blue Line
Behind you

No accessible transfer to
Blue Line. Use Jackson St.

Existing Station Shortcomings

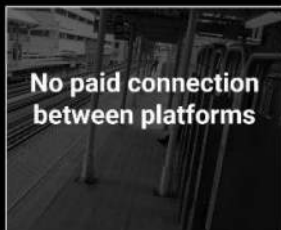
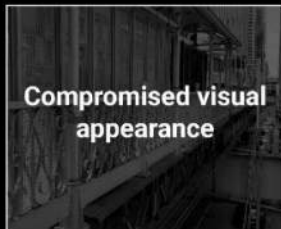
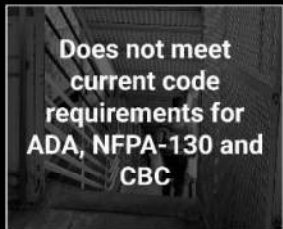

New Station Goals

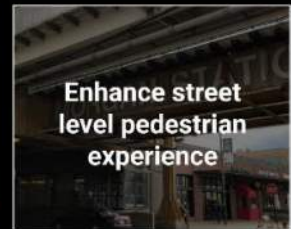

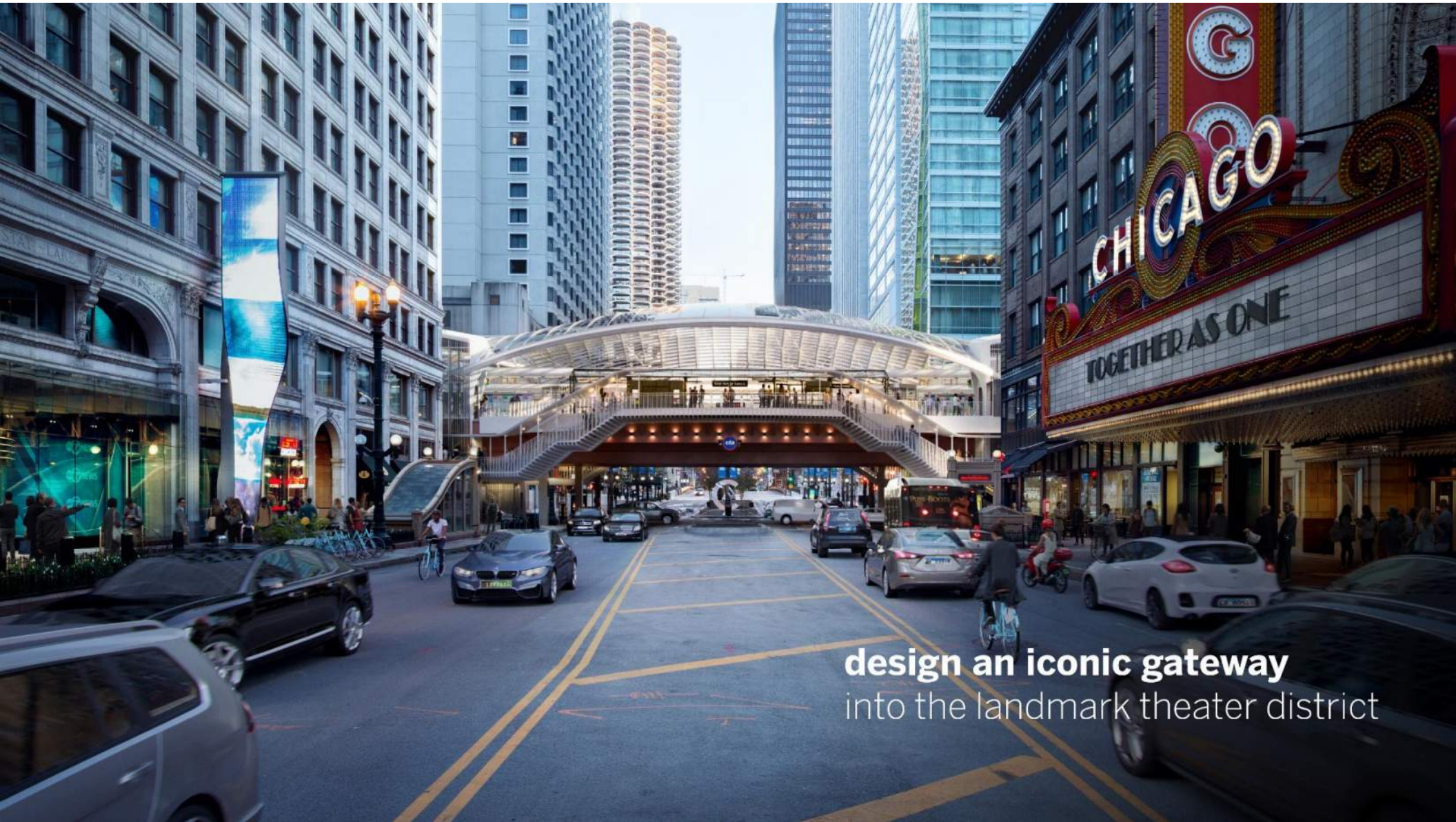

design an iconic gateway
into the landmark theater district

Increased Circulation Space within Station



Existing Platform

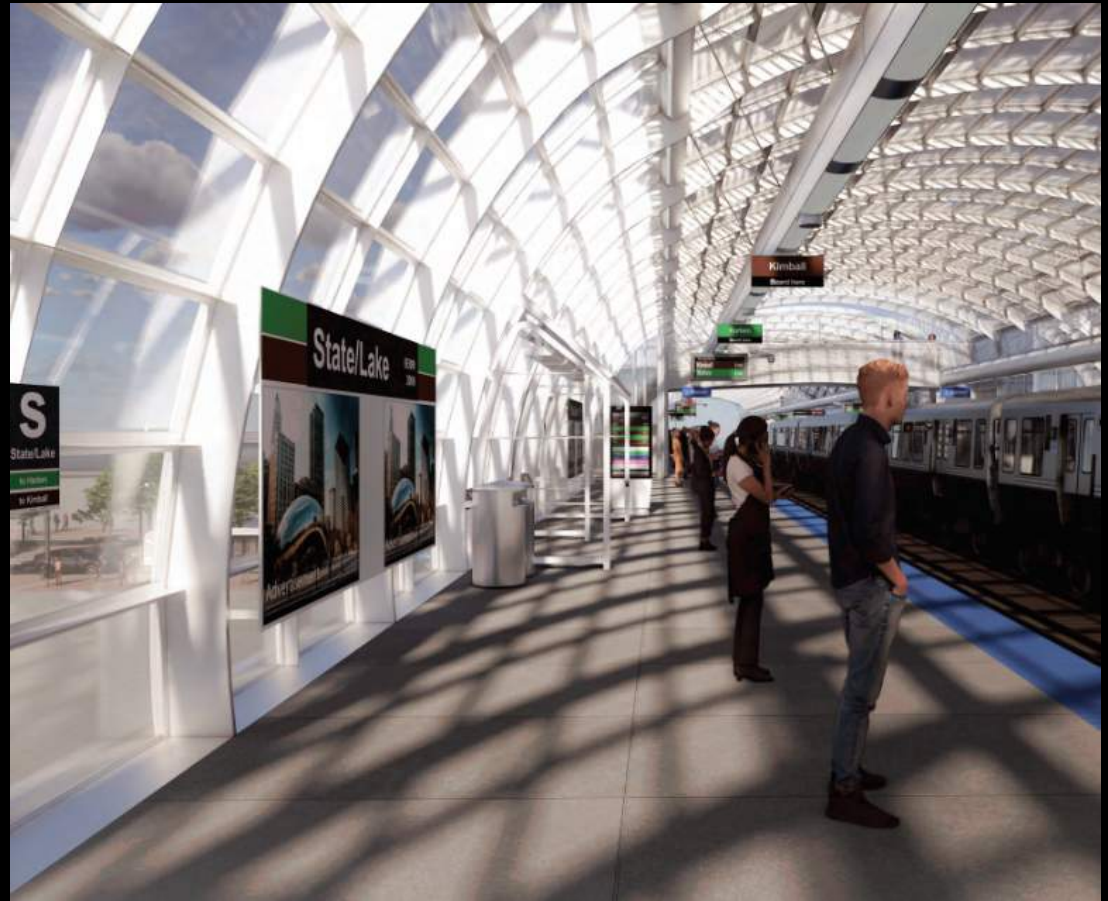

Proposed Platform

Columns to be Removed and Vertical Clearance Increased

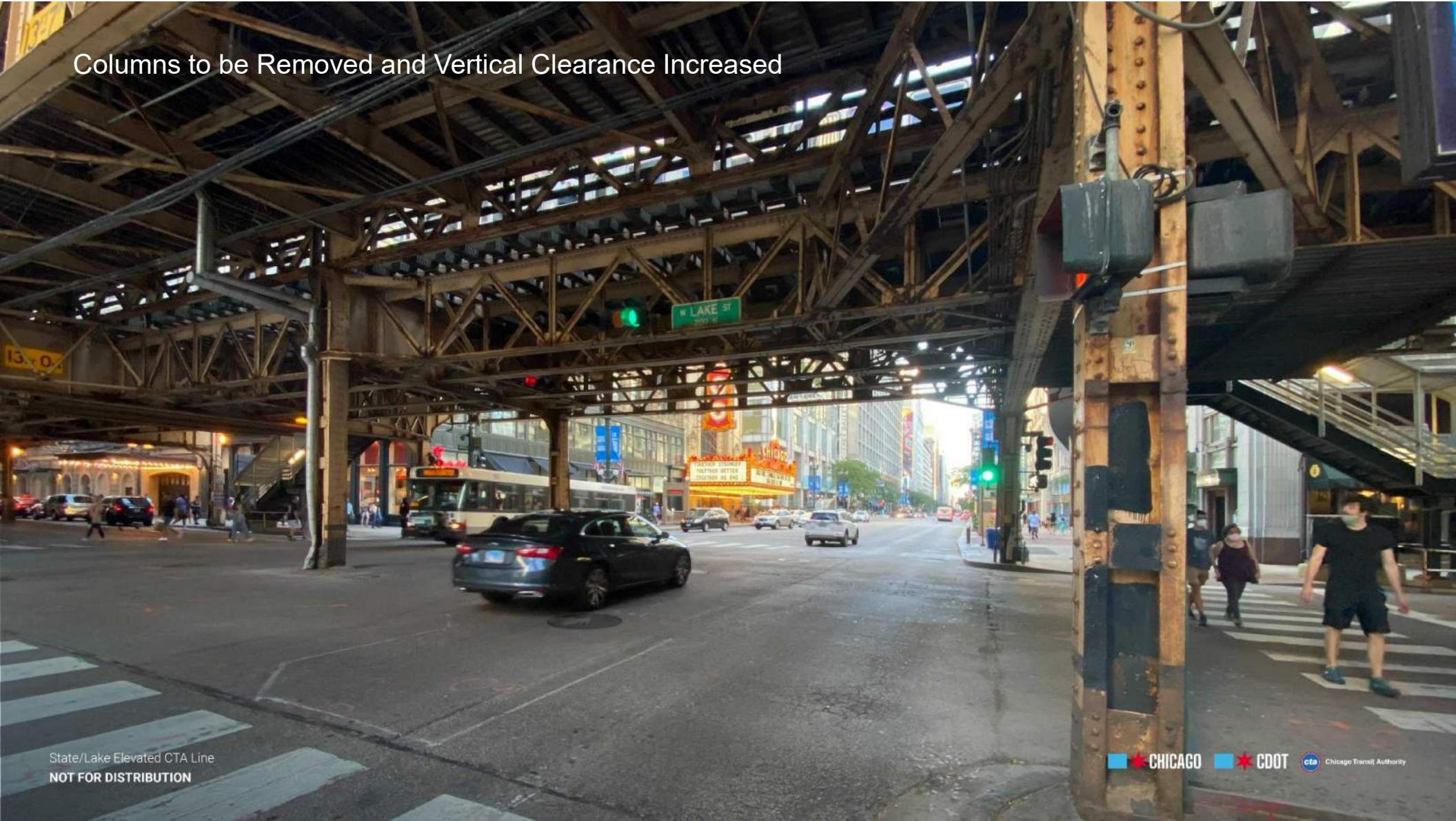

State/Lake Elevated CTA Line
NOT FOR DISTRIBUTION

**enhance the passenger
experience** within a protected
and accessible enclosure





State/Lake Elevated CTA Line
NOT FOR DISTRIBUTION

Platform Layout

Overhead/Canopy View

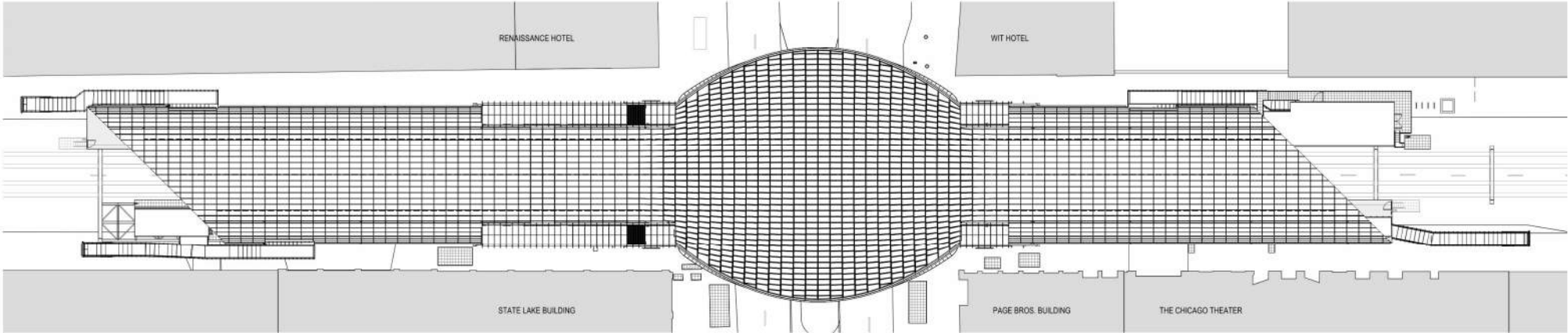

Platform Layout

Full Length

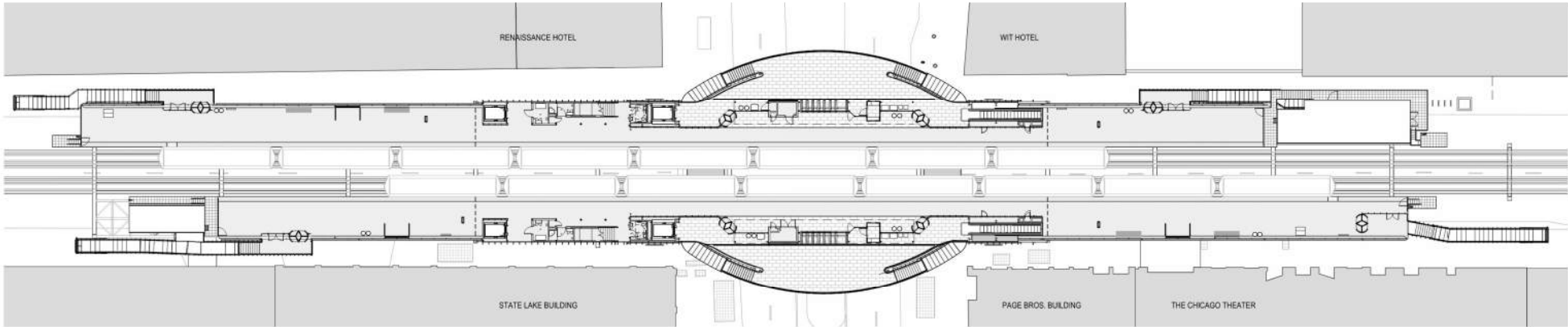

Platform Layout

Enlarged View of Center

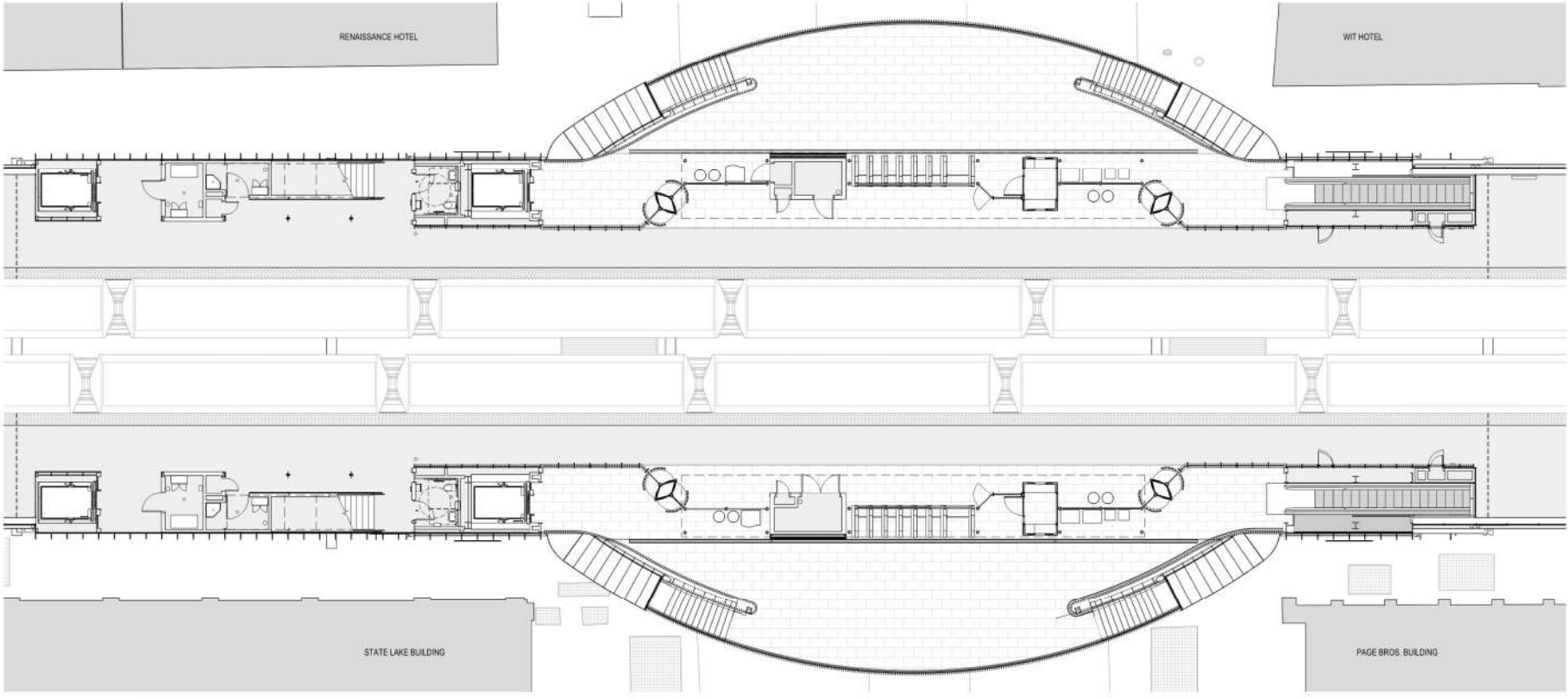

State and Lake Station

Electrical Room Location

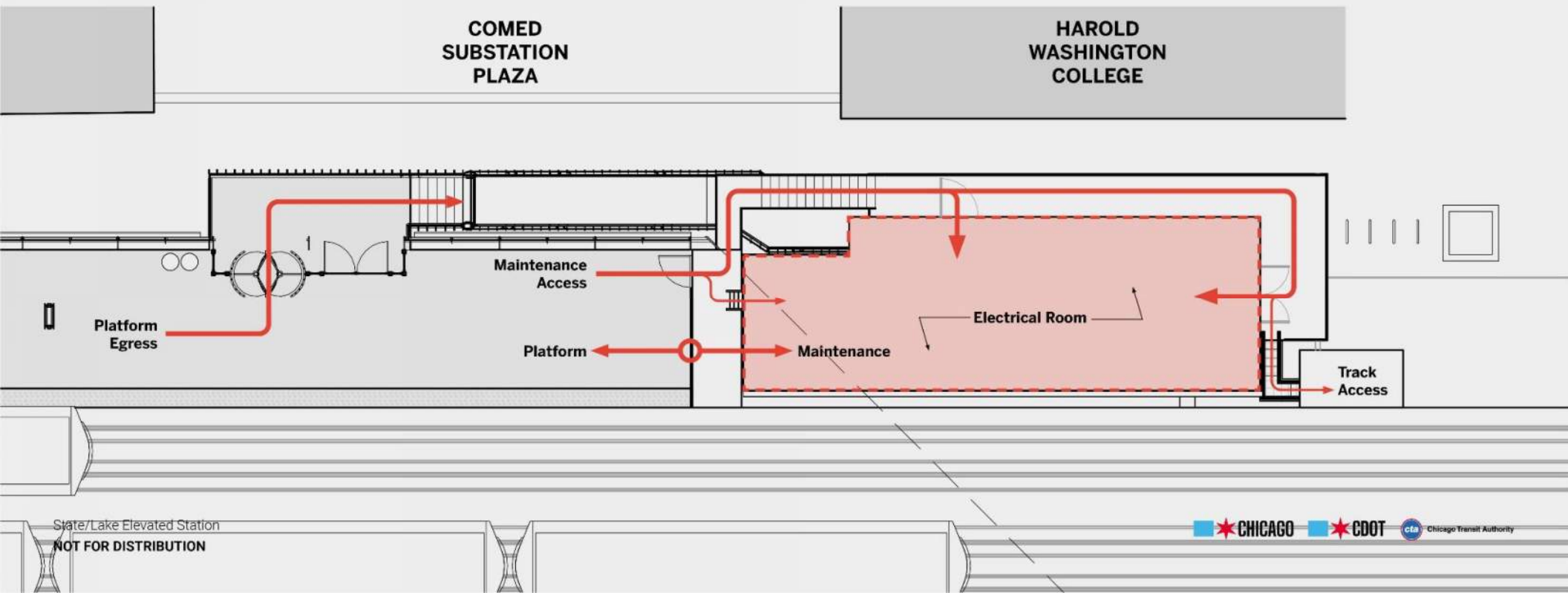

State/Lake Elevated Station
NOT FOR DISTRIBUTION



State/Lake Elevated Station
NOT FOR DISTRIBUTION

Station Entry

Stairs and Elevators

The configuration of the primary stair creates a pinch point between the adjacent buildings and the stair landing. Reconfiguring the stairs could help alleviate this congestion.

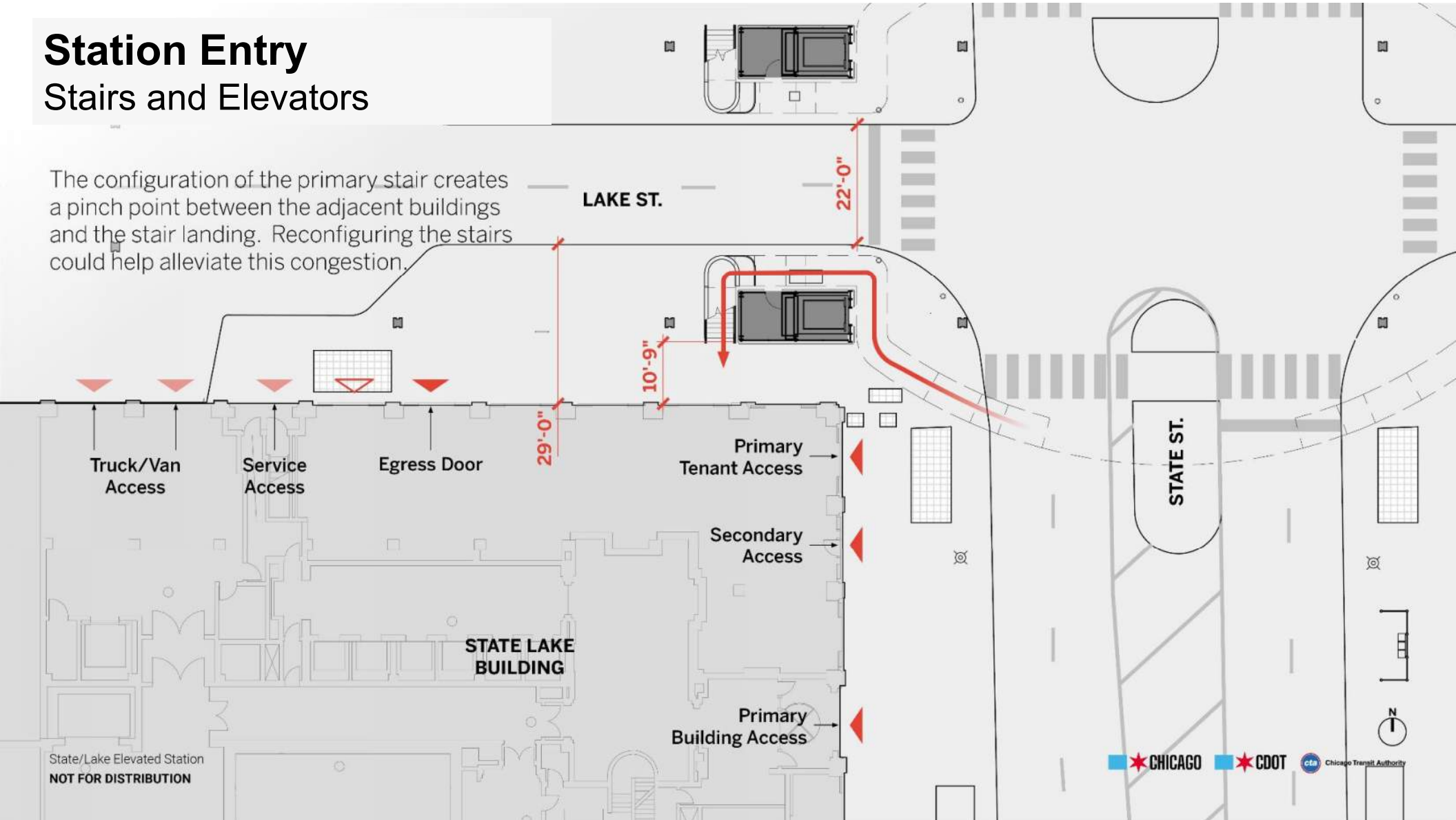

State/Lake Elevated Station
NOT FOR DISTRIBUTION

Location of Escalators

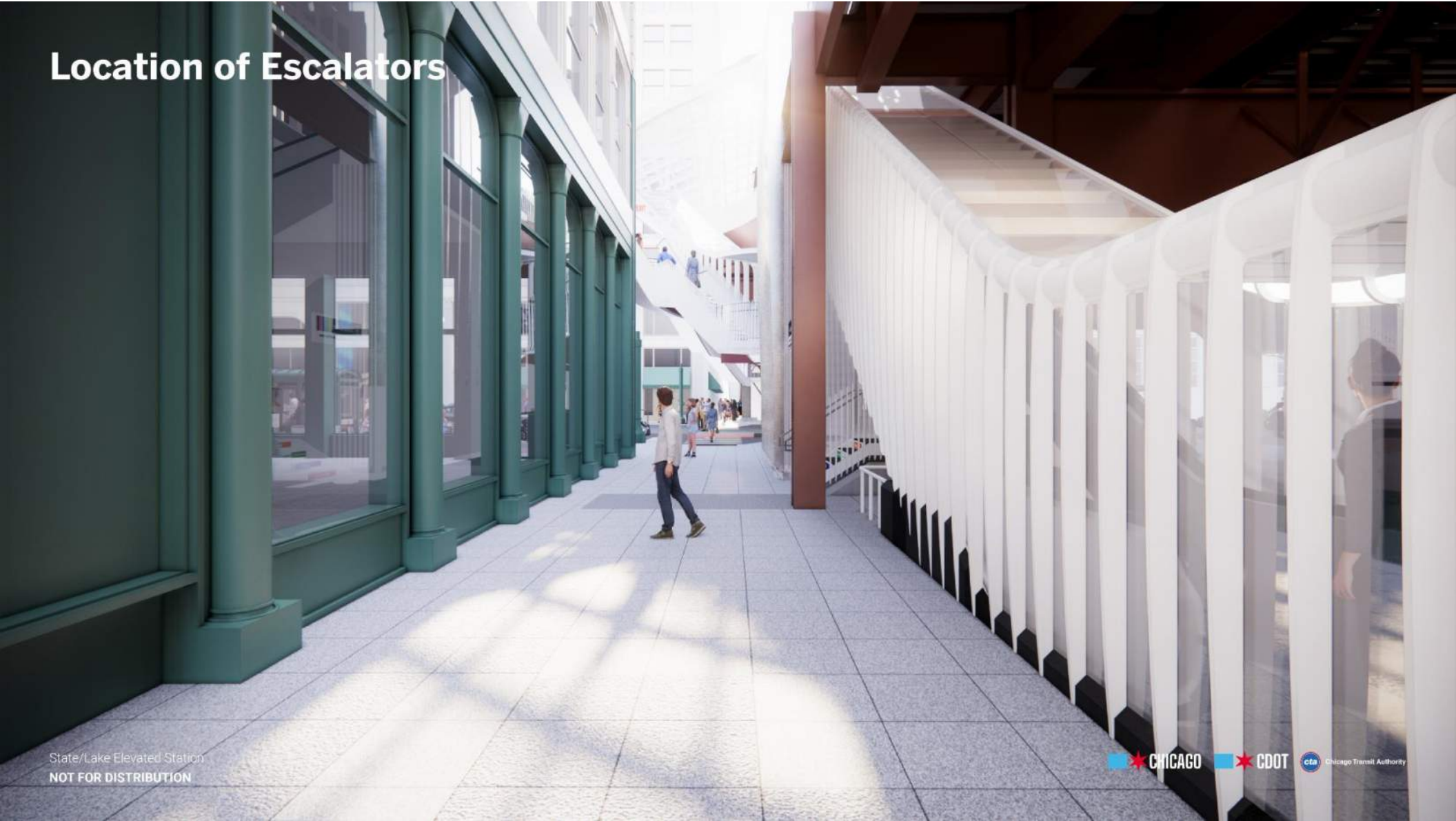

State/Lake Elevated Station
NOT FOR DISTRIBUTION

Station Entry

Stairs and Escalators

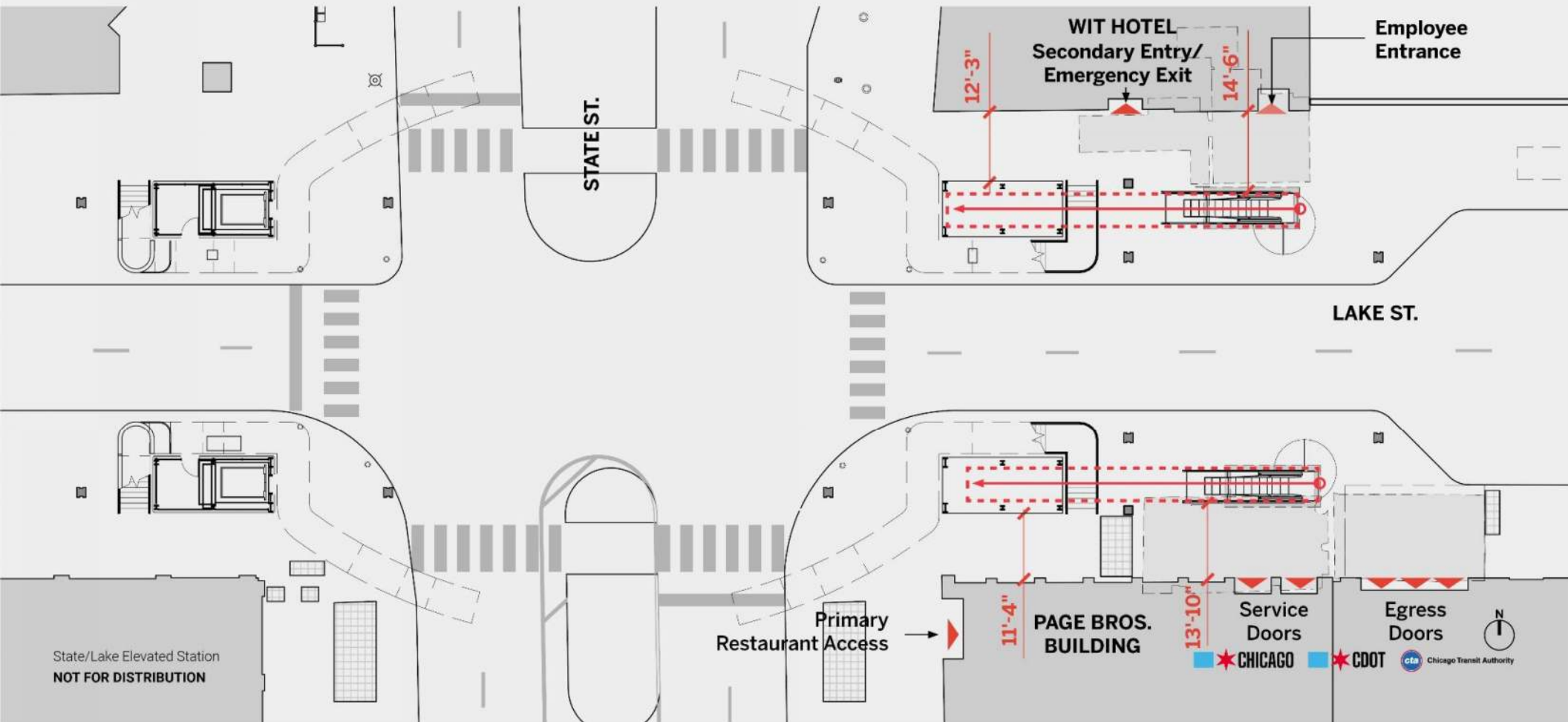

Street Safety

Currently, each crosswalk at the intersection of State Street and Lake Street is exceedingly long and is hazardous to pedestrian safety. Shortening this length and/or adding refuge islands would provide a better pedestrian environment.

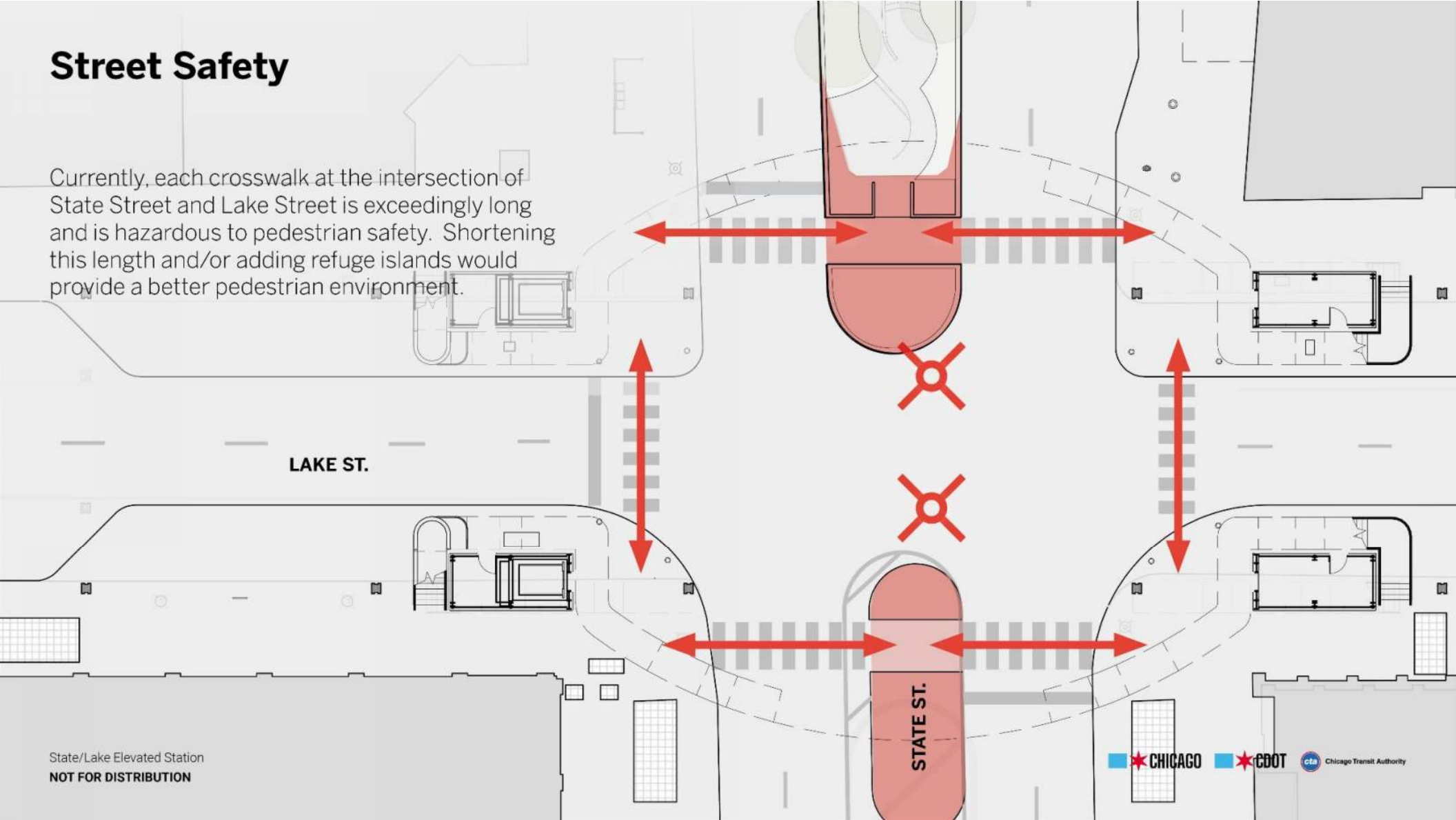

State/Lake Elevated Station
NOT FOR DISTRIBUTION



streetscape design to
enhance the public realm

State/Lake Elevated Station
NOT FOR DISTRIBUTION

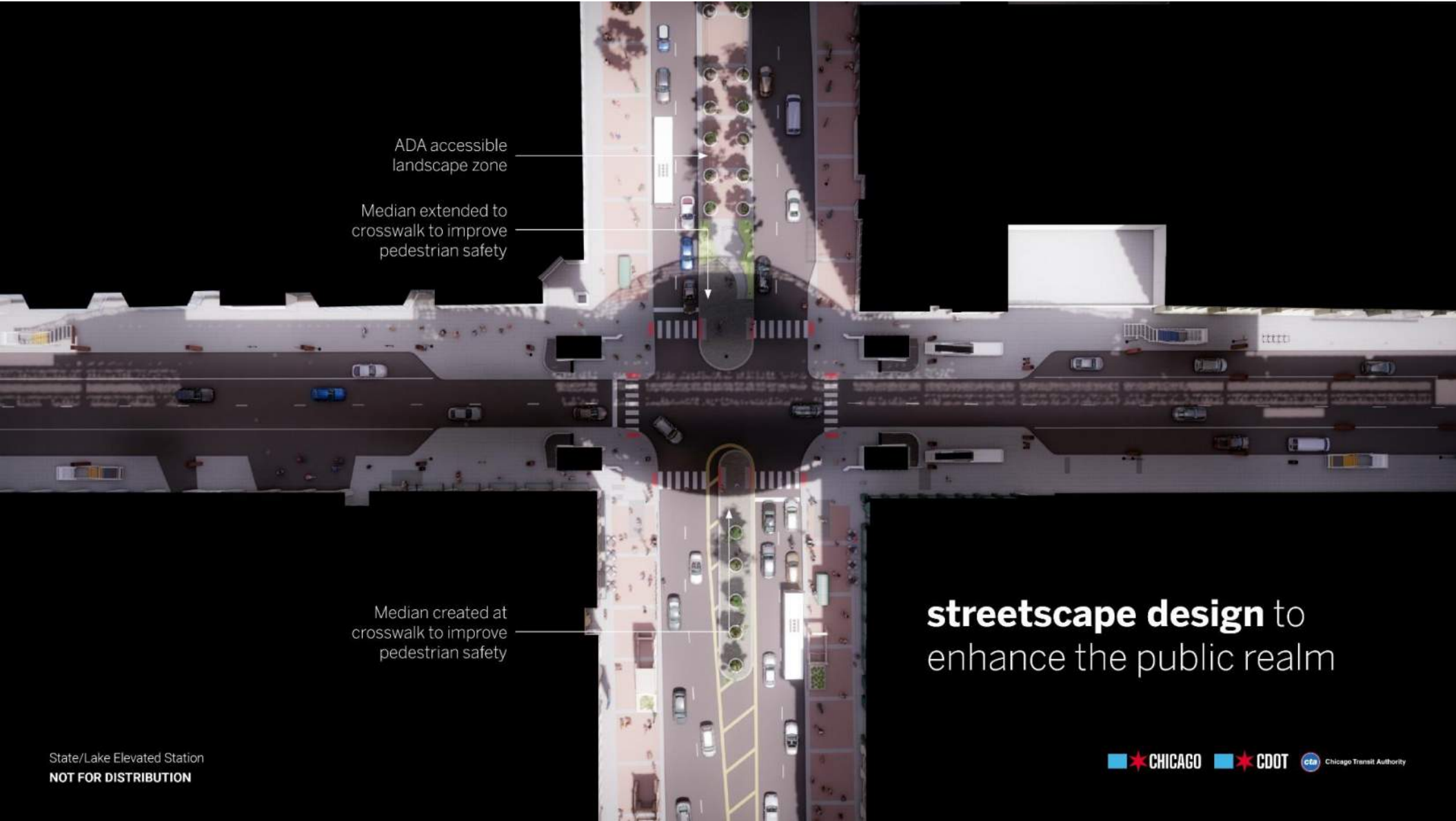

ADA accessible
landscape zone

Median extended to
crosswalk to improve
pedestrian safety

Median created at
crosswalk to improve
pedestrian safety

streetscape design to
enhance the public realm

State/Lake Elevated Station
NOT FOR DISTRIBUTION

South Median



State/Lake Elevated CTA Line
NOT FOR DISTRIBUTION

North Median Extension



State/Lake Elevated Station
NOT FOR DISTRIBUTION

Supplementary Lighting

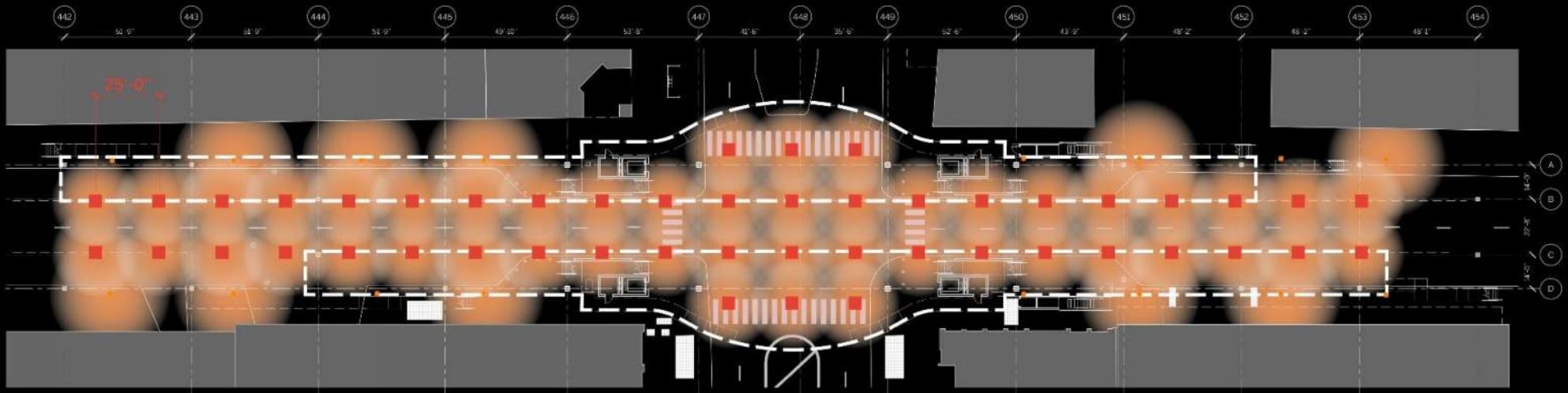

State/Lake Elevated Station
NOT FOR DISTRIBUTION

Sidewalk Vaults

DIAGRAM KEY

-  Sidewalk Vault to Remain
-  Sidewalk Vault Reconstruction



State/Lake Elevated Station
NOT FOR DISTRIBUTION



State/Lake Elevated CTA Line
NOT FOR DISTRIBUTION



State/Lake Elevated CTA Line
NOT FOR DISTRIBUTION

Subway

Mezzanine Level – New Elevators and Corridors

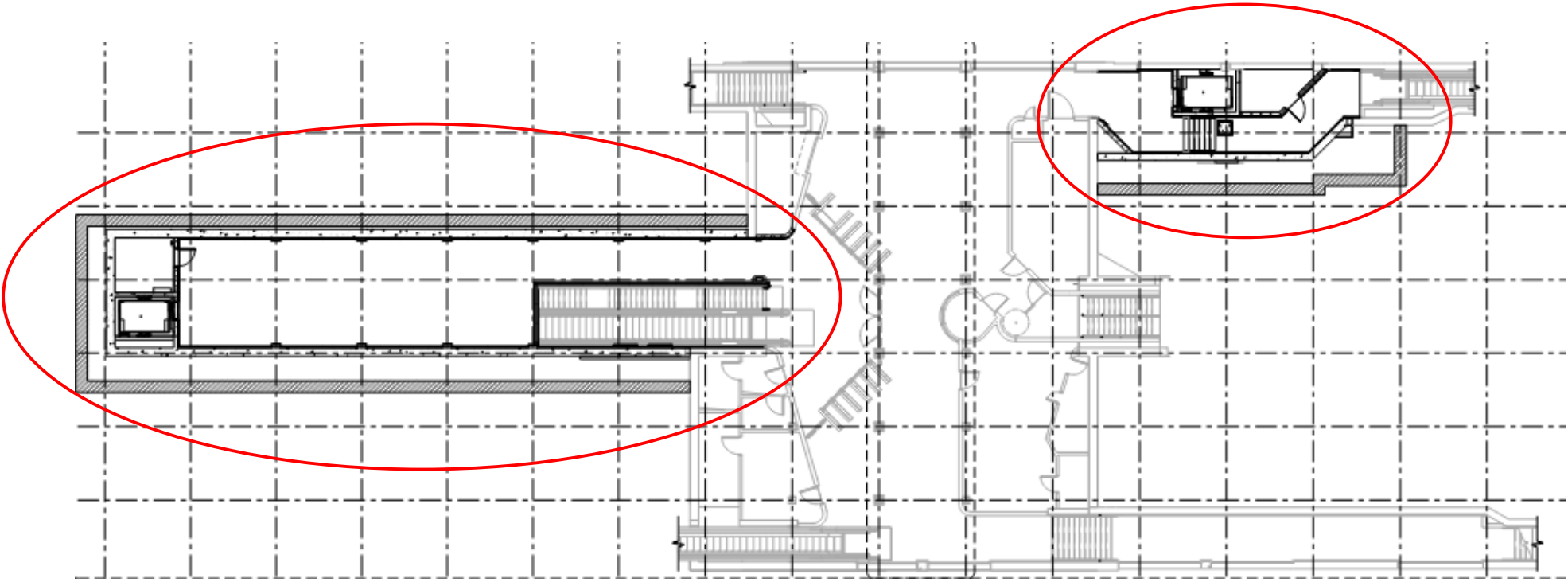

Construction Logistics

Draft Construction Staging* Sequence

*Actual milestones will be specified in the bid documents and detailed staging/scheduling will be developed by the contractor, subject to CDOT approval.

- Utility relocation by others 2022-2024
- Bidding in process
- Contractor NTP TBD
- Construction start TBD

Phase	Description	Month	1	2	3	4	5	6	7	8	9	10	11	12	13	14	15	16	17	18	19	20	21	22	23	24	25	26	27	28	29	30	31	32	33	34	35	36	37	38	39	40	41	42	43	44	45										
0	Pre-Mobilization, Shop Drawing, and Building Permit Phase																																																								
1	Elevated Station - Demolition																																																								
2	Elevated Station - Foundations																																																								
3	Elevated Station - State St Span Replacement																																																								
4	Elevated Station - Track Structure and Bent Modifications																																																								
5	Elevated Station - Platform Structure and Platforms																																																								
6	Elevated Station - Canopy and Transfer Bridge																																																								
7	Subway Station - Platform-Mezz Elevator and Platform Columns																																																								
8	Subway Station - Mezzanine-Sidewalk Elevator																																																								
9	Elevated Station - Vertical Conveyance																																																								
10	Elevated Station - MEP																																																								
11	Elevated Station - Finishes																																																								
12	Roadway and Sidewalk																																																								
13	Punchlist - Subway Station																																																								
14	Punchlist - Elevated Station																																																								
15	As-Built Drawings																																																								

<-Elevated Station Closes

<-Subway Station Work Starts

<-Subway Station Work Complete

<-Elevated Station Opens <-Final Completion

Draft Construction Staging*

CTA Track and Station Access

*Actual milestones will be specified in the bid documents and detailed staging/scheduling will be developed by the contractor, subject to CDOT approval.

- Loop trains run throughout the duration of the project
 - Limited weekend re-routes
- Elevated station closes for approximately 3 years
- Subway station remains open
 - Limited weekend closures
 - 1 month north mezzanine closure

Permissible Number of Track Re-Routes/Station Closures

Phase	Description	2 Track Elevated Weekend (54 hr)	2 Track Elevated Weekend (50 hr)	2 Track Elevated Sunday (12 hr)	1 Track Elevated Sunday (12 hr)	2 Track Subway Weekend (50hr)	2 Track Subway Sunday (12hr)	Lake/Randolph Subway Mezzanine Closure (up to 30 cal days)
0	Pre-Mobilization, Shop Drawing, and Building Permit Phase							
1	Elevated Station - Demolition				2			
2	Elevated Station - Foundations							
3	Elevated Station - State St Span Replacement	1						
4	Elevated Station - Track Structure and Bent Modifications							
5	Elevated Station - Platform Structure and Platforms				2			
6	Elevated Station - Canopy and Transfer Bridge		4	1				
7	Subway Station - Platform-Mezz Elevator and Platform Columns					2	1	1
8	Subway Station - Mezzanine-Sidewalk Elevator							
9	Elevated Station - Vertical Conveyance							
10	Elevated Station - MEP							
11	Elevated Station - Finishes							
12	Roadway and Sidewalk							
13	Punchlist - Subway Station							
14	Punchlist - Elevated Station							
15	As-Built Drawings							

Traffic Staging

Elevated Station Construction

DIAGRAM KEY

-  Work Area
-  Sidewalks to Remain Open
-  Loading Zone
-  Lane Markings
-  Construction Barriers
-  Path of Vehicular Travel

GENERAL NOTES

- Through traffic detour created
- Driveway and loading dock access permitted at most times
- Sidewalk business access maintained with canopy protection except for brief (~15 minute) interruptions during crane lifts
- Limited weekend and night closures of State Street (from Randolph to Wacker)

PHASES OF CONSTRUCTION

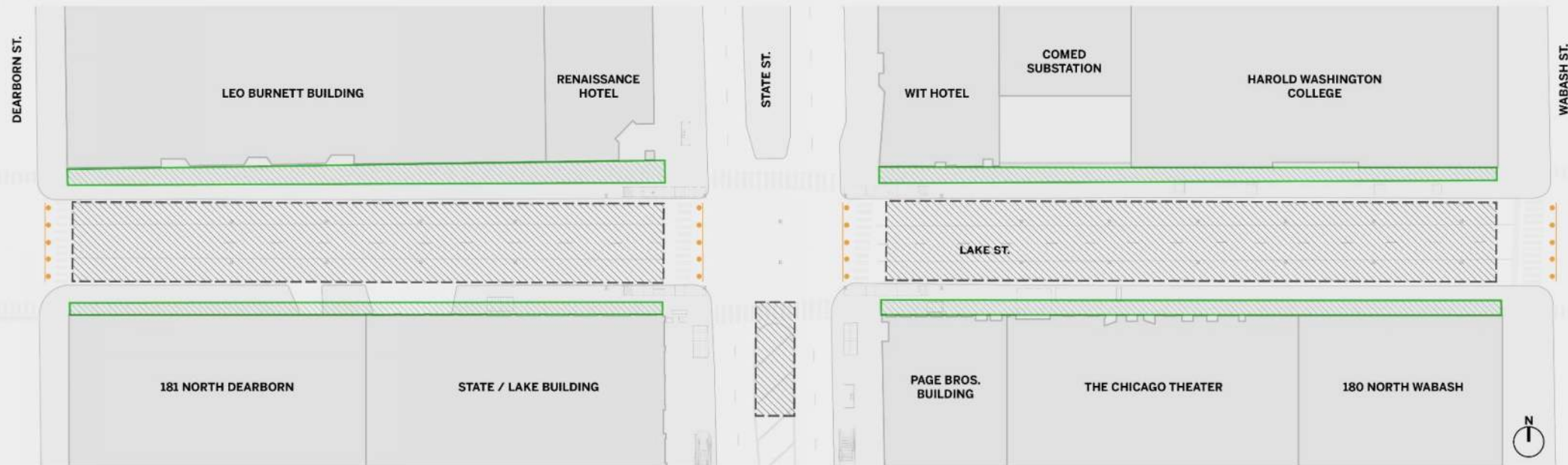







State/Lake Elevated Station
NOT FOR DISTRIBUTION

Traffic Staging

Elevated Station Construction

DIAGRAM KEY

-  Work Area
-  Sidewalks to Remain Open
-  Loading Zone
-  Lane Markings
-  Construction Barriers
-  Path of Vehicular Travel

GENERAL NOTES

- Through traffic detour created
- Access for deliveries and drop-offs provided with the limited access shown
- Sidewalk business access is maintained with canopy protection
- This configuration will be used when possible and construction activities permit

PHASES OF CONSTRUCTION

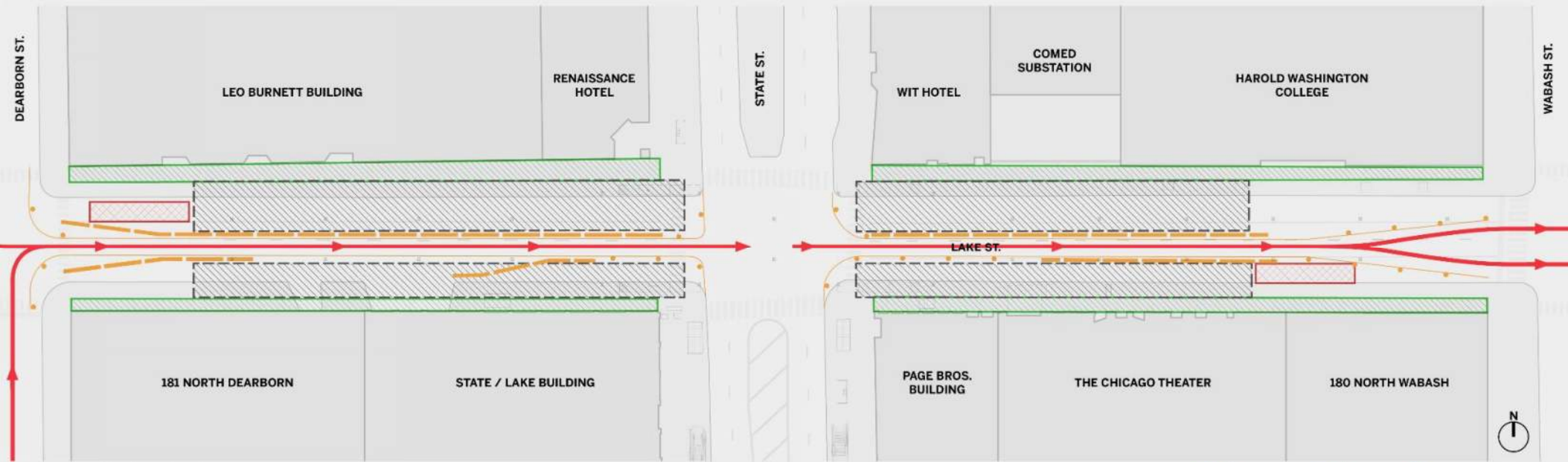

State/Lake Elevated Station
 NOT FOR DISTRIBUTION

Traffic Staging

Through Traffic Route and Detour – Lake St Closure

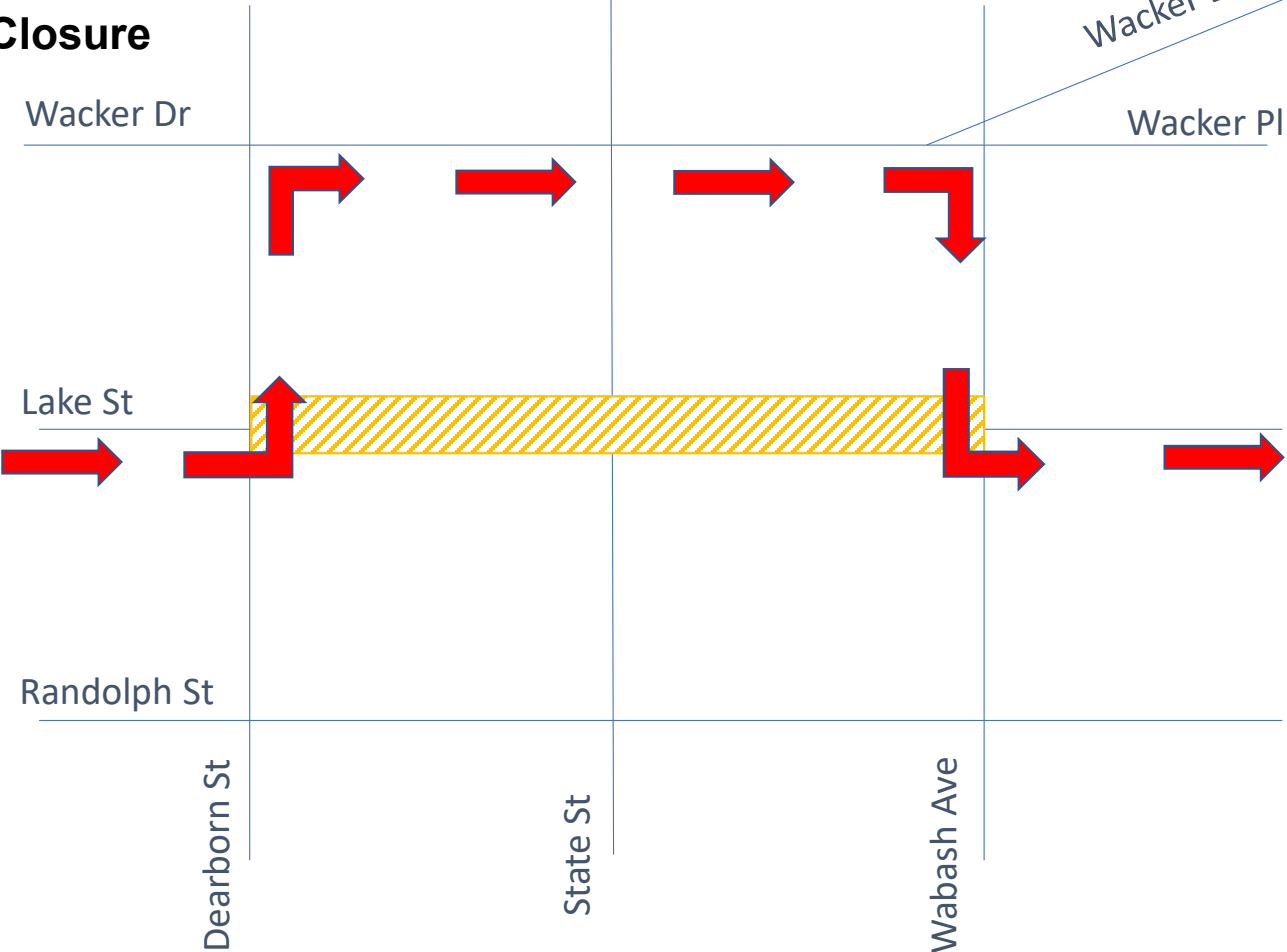

Temporary Sidewalk Canopy Protection and Business Signage



State/Lake Elevated Station
 NOT FOR DISTRIBUTION

Temporary Sidewalk Canopy Protection

DIAGRAM KEY

 Temporary Overhead Sidewalk Protection



4\"/>

HINGED ACCESS GATE WITH SIGNAGE ON STREET SIDE FOR FIRE DEPT ACCESS. SEE G006 FOR LOCATIONS.

AREA TO RECEIVE CUSTOM COLOR GRAPHICS. DIGITAL FILE PROVIDED BY COMMISSIONER CONTRACTOR TO PRINT ON PEEL AND STICK VINYL. PRINT PRIOR TO INSTALLATION.

PLYWOOD PARTITION PAINT WHITE

3\"/>

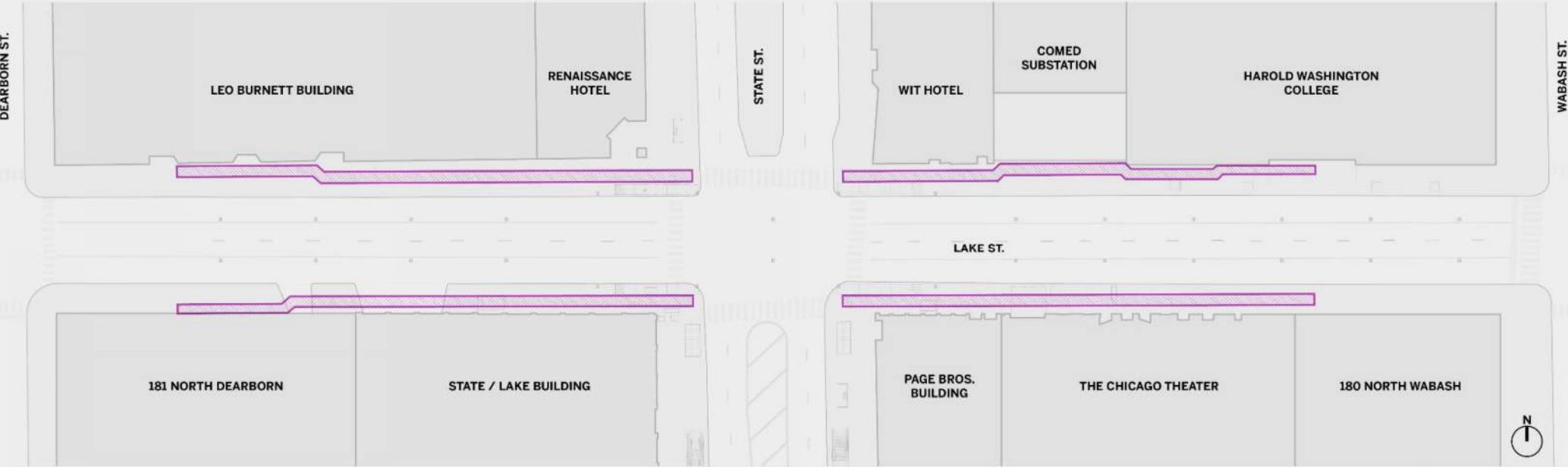

State/Lake Elevated Station
NOT FOR DISTRIBUTION

Traffic Staging

Subway Station Platform and Mezzanine Elevator Construction

DIAGRAM KEY

-  Work Area
-  Sidewalks to Remain Open
-  Loading Zone
-  Lane Markings
-  Construction Barriers
-  Path of Vehicular Travel

GENERAL NOTES

- Sidewalk, vehicular and bus traffic is maintained during construction

PHASES OF CONSTRUCTION

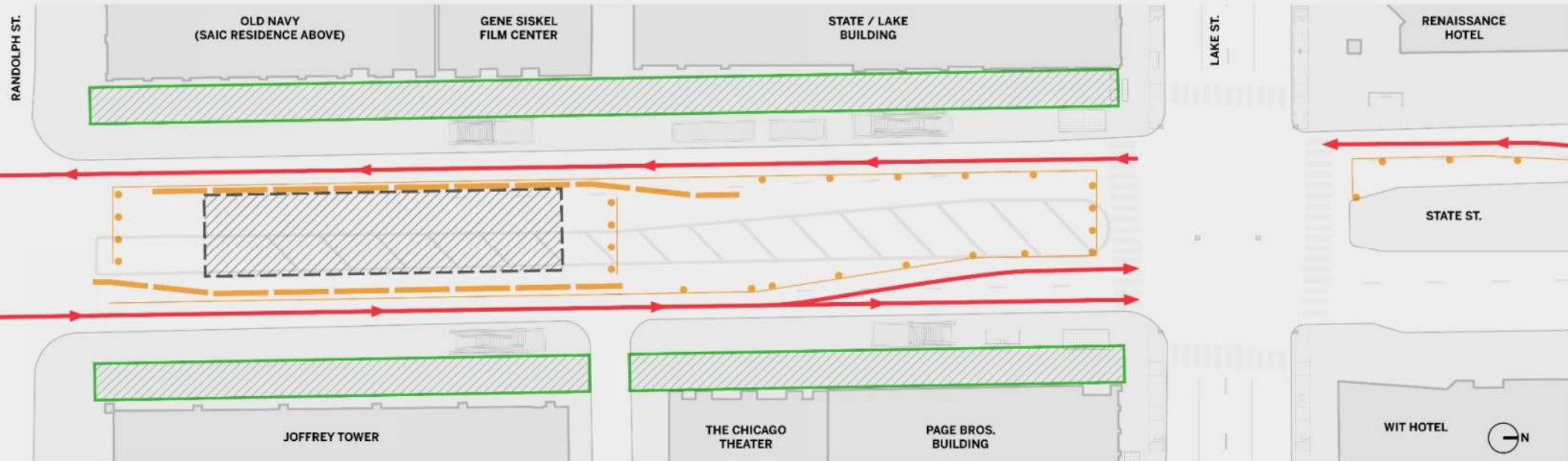







State/Lake Elevated Station
NOT FOR DISTRIBUTION

Traffic Staging

Subway Station Platform and Sidewalk Elevator Construction

DIAGRAM KEY

-  Work Area
-  Sidewalks to Remain Open
-  Loading Zone
-  Lane Markings
-  Construction Barriers
-  Path of Vehicular Travel

GENERAL NOTES

- Sidewalk, vehicular and bus traffic is maintained during construction

PHASES OF CONSTRUCTION

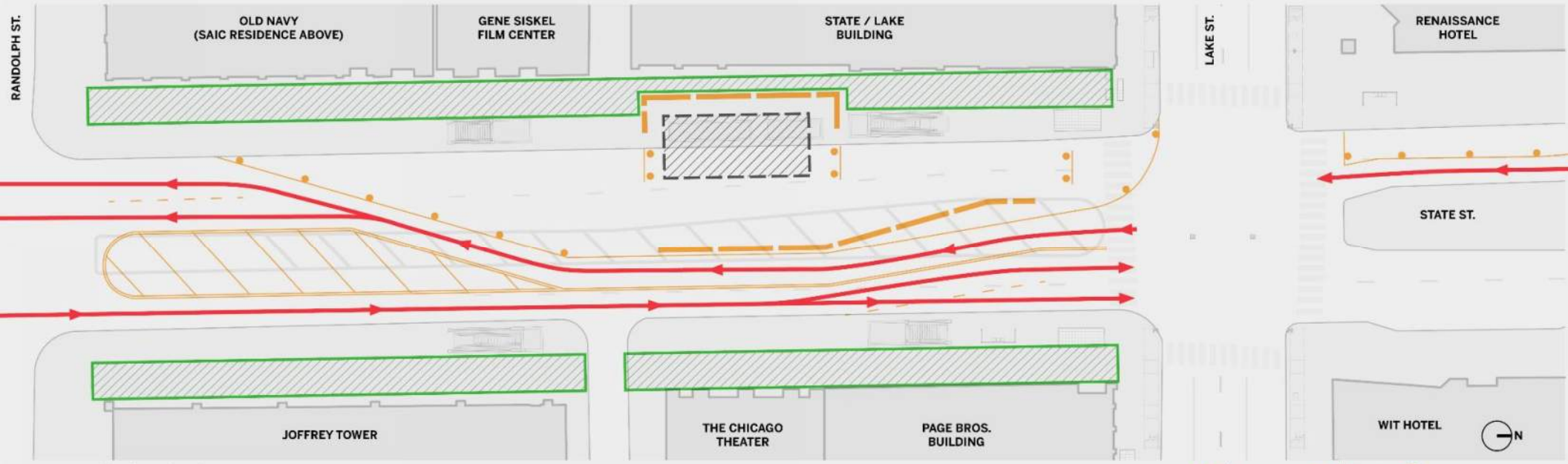

State/Lake Elevated Station
NOT FOR DISTRIBUTION

Traffic Staging

Detour – State St Closure (Limited Weekends)

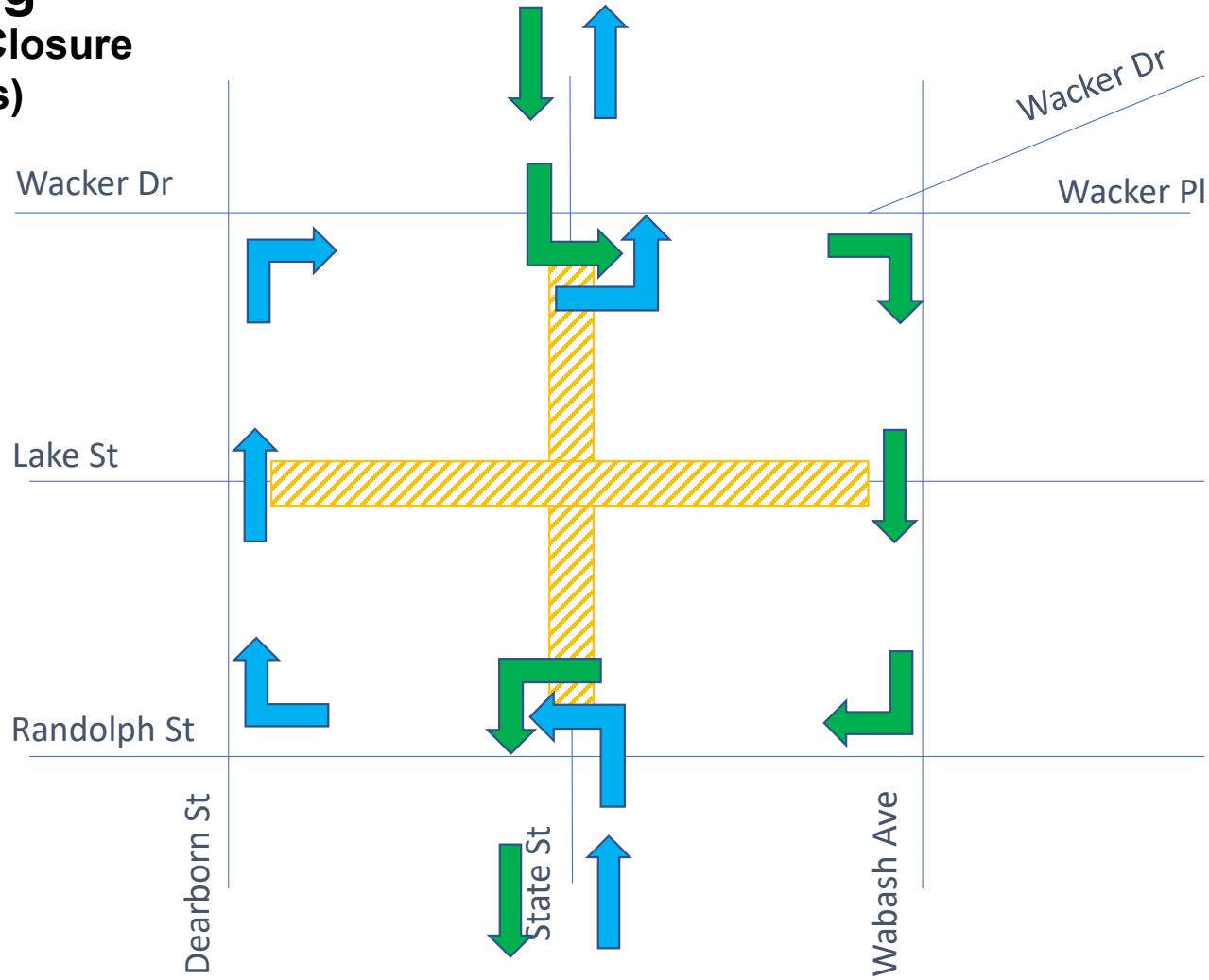

Artist Coordination

Sculpture Placement

Objects are to be placed along the outer perimeter of the platform to provide a clear path of travel for all passengers.

The sculptures shall provide a minimum of 18" of clearance from the perimeter structure and rely upon the approved anchorage to the platform for its own stability.

Locate one object at each quadrant of the platform for a total of four installations.

The footprint of each sculpture should fit within a 5'-0" x 5'-0" bounding box.

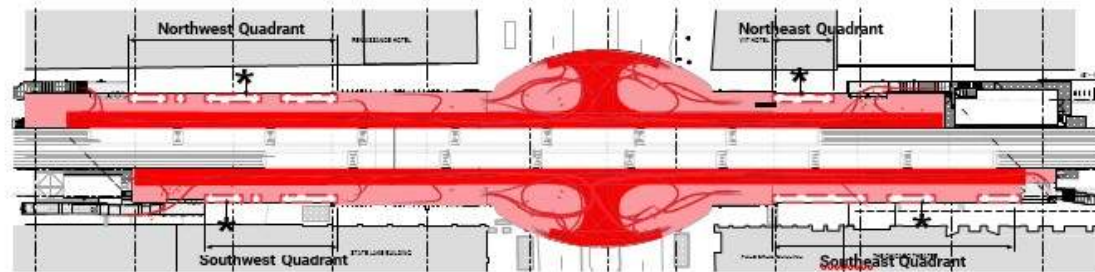

Plan Diagram

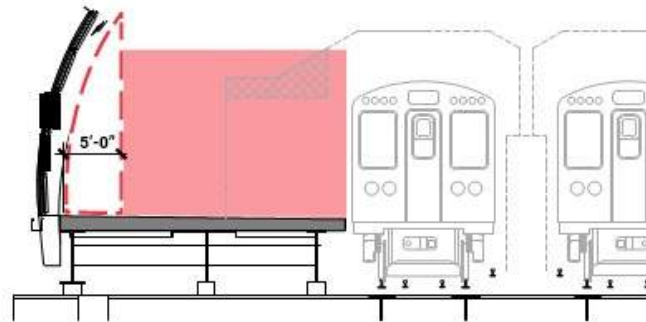

Section Diagram

- Areas of Primary Passenger Flows
- Open Areas
- Proposed Sculpture Location

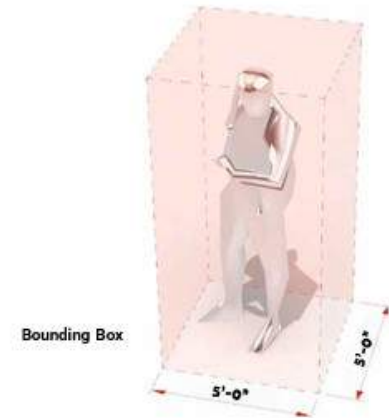

Bounding Box

Artist Coordination

1. DCASE will commission an artist for station artwork.
2. Contractor and artist to coordinate schedule for interaction.
3. Artist to provide loading and anchoring information to contractor for inclusion in precast platform calculations and submittals.
4. Contractor to design and fabricate precast panels to accommodate art.
5. Artist and contractor to mock-up installation before delivery of artwork.
6. Artist to fabricate and deliver art to site.
7. Contractor to install and protect art.

FTA Safety and Security Certification (SSC) Process

1. Work with CDOT, CTA, Engineering Consultants, and Illinois State Safety Oversight Authority (IDOT OIPI).
2. Follow and update project Safety and Security Certification Plan (SSCP) in specifications.
3. Perform required documentation, testing, and certification as certifiable items and elements are manufactured, fabricated, delivered, and installed.

FTA-MA-90-5006-02-01
DOT-VNTSC-FTA-02-01



Handbook for Transit Safety and Security Certification

Prepared by:
U.S. Department of Transportation
Research and Special Programs Administration
John A. Volpe National Transportation Systems Center
Cambridge, MA 02142-1093

Final Report
November 2002

Prepared for:
Federal Transit Administration
Office of Safety and Security
Washington, DC 20590



FTA OFFICE OF SAFETY AND SECURITY



1269715: State/Lake Loop Elevated Station Pre-Bid Conference Attendee Register

Using Department: Department of Transportation (CDOT)
 Procurement Specialist: Luis Bejar, Email: Luis.Bejar@CityofChicago.Org
 Specification Number: 1269715
 Conference Date: Thursday February 1, 2024
 Conference Location: City of Chicago, 2 North LaSalle, 2N Mezzanine Conference Center, Great Fire, Chicago, IL
 Conference Time: 10:00 A.M.

Attendee Name: Chris Meissner
 Company Name: Rail Works Track Services
 Company Address: 201 S Carpenter St.
Chicago IL 60645
 Telephone: 773.447.5892
 Fax: _____
 E-Mail: cmeissner@railworks.com
 Please print clearly



RYAN GIERTZ
 Estimator / Project Manager
 312 585.7445 Direct
 773.360.4734 Mobile
 269.353.8435 Fax
 ryan.giertz@nicholsonconstruction.com
 8725 W Higgins Rd. Ste 820 | Chicago, IL 60631-2716

Attendee Name: Javid Aboutorabi
 Company Name: Clark Construction
 Company Address: 216 S Jefferson, S02
Chicago, IL 60661
 Telephone: 312-258-5481
 Fax: _____
 E-Mail: javid.aboutorabi@clarkchicago.com
 Please print clearly

Galaxy Environmental, Inc
 MBE/DBE Certified
George A. Salinas
 President
 PO BOX 411028
 Chicago, IL 60641-1028
 Phone: (773) 427.2980
 Fax: (773) 427.2982
 Mobile: (312) 907.3952
 gsalinas@geigc.com



Joseph Pustis
 Vice President

Clark Construction Group - Chicago LLC
 216 South Jefferson Street, Suite 502
 Chicago, Illinois 60661
 Phone 312/474-5500
 Mobile 301/717-2505
 email joe.pustis@clarkchicago.com

Brian R. Wasielewski
 CEO

SPECIALTY CONSTRUCTION
 608 W. Winthrop Ave. | Addison, IL 60101 | www.sc-chicago.com
 O: 630-317-7117 x1000 | C: 630-688-6161 | brw@sc-chicago.com



Joseph S. Sadowski
 Project Executive

Clark Construction Group - Chicago LLC
 216 South Jefferson Street, Suite 502
 Chicago, Illinois 60661
 Phone 312/474-5500 Fax 312/474-5521
 Mobile 312/350-7226
 email joe.sadowski@clarkchicago.com

Galaxy Environmental, Inc
 MBE/DBE Certified
Michael Chagoya
 Estimator/Project Manager
 PO BOX 411028
 Chicago, IL 60641-1028
 Office (773) 427.2980
 Fax (773) 427.2982
 Mobile: (312) 656.7524
 mchagoya@geigc.com

1269715: State/Lake Loop Elevated Station Pre-Bid Conference Attendee Register

Using Department: Department of Transportation (CDOT)
Procurement Specialist: Luis Bejar, Email: Luis.Bejar@CityofChicago.Org
Specification Number: 1269715
Conference Date: Thursday February 1, 2024
Conference Location: City of Chicago, 2 North LaSalle, 2N Mezzanine Conference Center, Great Fire, Chicago, IL
Conference Time: 10:00 A.M.

Attendee Name: Joel Valdivia
 Company Name: Era-Valdivia Contractors
 Company Address: 11909 S Avenue O
Chicago, IL 60617
 Telephone: (773) 721-9350
 Fax: _____
 E-Mail: joelvaldivia@eravaldivia.com
 Please print clearly

CHICAGO STEEL GROUP

Jon Hollowell
President

4433 East 83rd Avenue • Merrillville, Indiana 46410-6613
 (219) 947-3939 • Fax (219) 947-7215
 Mobile: (708) 906-7681 • e-mail: jhollowell@chicagosteelgroup.com
 Website: www.chicagosteelgroup.com

Attendee Name: Tom Long
 Company Name: Chicago Steel
 Company Address: Merrillville, IN
 Telephone: 312 838 1714
 Fax: _____
 E-Mail: tlong@chicagosteelgroup.com
 Please print clearly

Lindner | Building New Solutions

Bryan McWherter
U.S. Sales Director

Lindner Facades, Inc.

Phone: +1 267 245 2858
Bryan.McWherter@Lindner-Group.com

185 Discovery Drive
 Colmar, PA 18915
www.Lindner-Group.com

Attendee Name: Joe Sant'andrea
 Company Name: Kiewit
 Company Address: 2 Pierce Place
Itasca, IL 60143
 Telephone: 773-640-1440
 Fax: _____
 E-Mail: Joseph.Santfilippo@kiewit.com
 Please print clearly

Thomas D. McElroy, II
Principal & CEO
tdm@level-1.com

IT Starts Here.

The Willis Tower | 233 South Wacker Drive | Suite 4400
 Chicago, Illinois 60606 USA
 Voice 312.202.3300 | www.level-1.com | Fax 312.202.3310

Attendee Name: JOE PUSTIS
 Company Name: CLARK CONSTRUCTION
 Company Address: 216 S. JEFFERSON ST
SUITE 502
 Telephone: (312) 777-2505
 Fax: _____
 E-Mail: Joe.pustis@clarkconstruction.com
 Please print clearly

dukane|precast

OFFICE: 630-355-8118
 DIRECT: 630-548-6586
 CELL: 331-215-3014

Scott Gale
Vice President of Sales

1805 High Grove Lane
 Suite 137
 Naperville, IL 60540-3987

Email: sgale@dukaneprecast.com
www.dukaneprecast.com

1269715: State/Lake Loop Elevated Station Pre-Bid Conference Attendee Register

Using Department: Department of Transportation (CDOT)
Procurement Specialist: Luis Bejar, Email: Luis.Bejar@CityofChicago.Org
Specification Number: 1269715
Conference Date: Thursday February 1, 2024
Conference Location: City of Chicago, 2 North LaSalle, 2N Mezzanine Conference Center, Great Fire, Chicago, IL
Conference Time: 10:00 A.M.

Attendee Name: SVEN BOSOLD
Company Name: WALSH CONSTRUCTION COMPANY II, LLC
Company Address: 929 W ADAMS ST
Telephone: 312-907-2192
Fax: sbsold@walshgroup.com
E-Mail: _____
 Please print clearly

Attendee Name: DAVID CASTEEL
Company Name: SAFWAY ATLANTIC
Company Address: 5000 S HOMAN AVE
CHICAGO IL
Telephone: 219-313-6877
Fax: _____
E-Mail: D CASTEEL@SAFWAYATLANTIC.COM
 Please print clearly

Attendee Name: JOE SANCUSKI
Company Name: CLARK CONSTRUCTION
Company Address: _____
Telephone: (312) 350-7220
Fax: _____
E-Mail: joe.sancuski@clarkchicago.com
 Please print clearly



Galaxy Environmental, Inc.

MBE/DBE Certified

JOSE LAGUNA
PROJECT ASSISTANT

JLAGUNA@GEIGC.COM

MOBILE: 773.380.9856
OFFICE: 773.427.2980

3565 NORTH MILWAUKEE AVENUE
CHICAGO, ILLINOIS 60641



Clark Construction Group - Chicago LLC
 216 South Jefferson Street, Suite 502
 Chicago, Illinois 60661
 Cell: (312) 914-9715
 rachel.drouillard@clarkchicago.com

Rachel Drouillard
Preconstruction Manager

JOE SANFILIPPO, P.E.
Project Manager

KIEWIT INFRASTRUCTURE CO.
 Two Pierce Place, Suite 1600, Itasca, IL 60143
 joseph.sanfilippo@kiewit.com
 773-458-1250 main
 773-640-1440 cell
 kiewit.com

*Licensed in the state(s) of IL



BRAND SAFWAY.

David Casteel
 Sales / Project Manager
 P 708 553 0342 | C 219 313 6877
 dcasteel@safwayatlantic.com



Safway Atlantic LLC
 5000 S Homan Ave
 Chicago, Illinois 60632-3059
 www.brandsafway.com



Sven Bosold
 Sr. Project Manager
 Heavy Highway/Civil Division

929 W. Adams Street
 Chicago, Illinois 60607
 Tel: 312.563.5400
 Fax: 312.563.5447
 Cell: 312.907.2192
 www.walshgroup.com
 email: sbsold@walshgroup.com

1269715: State/Lake Loop Elevated Station Pre-Bid Conference Attendee Register

Using Department: Department of Transportation (CDOT)
 Procurement Specialist: Luis Bejar, Email: Luis.Bejar@CityofChicago.Org
 Specification Number: 1269715
 Conference Date: Thursday February 1, 2024
 Conference Location: City of Chicago, 2 North LaSalle - 2nd Floor Mezzanine Conference Center, Great Fire, Chicago, IL
 Conference Time: 10:00 A.M.

Attendee Name: Shoshiwa Mabina
 Company Name: CDOT
 Company Address: 2 N. LaSalle
 Telephone: _____
 Fax: _____
 E-Mail: shoshiwa.mabina@cityofchicago.org
Please print clearly



BUILD WITH PASCHEN

MICHAEL RICKERT
Project Engineer

mrickert@fhpaschen.com

o. 773.444.3474

f. 773.693.0064

www.fhпасchen.com
 5515 N. East River Road
 Chicago, IL 60656



BUILD WITH PASCHEN

MARCIN NIERADKA
Project Engineer

mnieradka@fhpaschen.com

d. 773.444.1578

www.fhпасchen.com
 5515 N. East River Road
 Chicago, IL 60656

{Business Card}

CRAIG VOSS

Estimator

1211 West 22nd Street, Suite 102

Oak Brook, IL 60523

C: 815.666.0454

E: craig.voss@lenexsteel.com | lenexsteel.com

CHICAGO STEEL

Tom Long

Director of Business Development

4433 East 83rd Avenue • Merrillville, Indiana 46410-6613

(219) 947-3939 • Fax (219) 947-7215

Mobile: (312) 888-1714 • e-mail: tlong@chicagosteelgroup.com

www.chicagosteelgroup.com

JADE

CARPENTRY CONTRACTORS, INC.

DBE / WBE / WOSB Certified

145 BERNICE DRIVE
 BENSENVILLE, IL 60106

773/594-1600

FAX: 773/594-0442

NaomiC@jadecarpentry.com

Naomi Calmatuianu
 Executive Vice President

CHANDLER HARNISH

Operations Manager

1211 West 22nd Street, Suite 102

Oak Brook, IL 60523

C: 260.273.1759

E: chandler.harnish@lenexsteel.com | lenexsteel.com

1269715: State/Lake Loop Elevated Station Pre-Bid Conference Attendee Register

Using Department: Department of Transportation (CDOT)
Procurement Specialist: Luis Bejar, Email: Luis.Bejar@CityofChicago.Org
Specification Number: 1269715
Conference Date: Thursday February 1, 2024
Conference Location: City of Chicago, 2 North LaSalle, 2N Mezzanine Conference Center, Great Fire, Chicago, IL
Conference Time: 10:00 A.M.

W.E. O'Neil Construction Co.



1245 W. Washington Blvd.
 Chicago, IL 60607
 Telephone 773.755.1611
 Direct 773.590.4536
 Fax 773.584.0866
 Email tricordati@weoneil.com

Tony Ricordati
 Project Director



A. Rocky Rossetti
 Chief Estimator
 Midwest Heavy Civil Division

Walsh Construction
 929 West Adams Street
 Chicago, Illinois 60607
 Tel: 312.563.5400
 Cell: 312.656.0798
www.walshgroup.com
rrossetti@walshgroup.com



Norbert Maier
 Business Development Manager -
 Gartner North America

JOSEF GARTNER
 A Division of PERMASTEELISA
 NORTH AMERICA CORP.
 1300 Hall Blvd, Suite 1A
 Bloomfield, CT 06002, United States
 T: +1 860 298 2000
 M: +1 959 333 8451
n.maier@permasteelisagroup.com
www.permasteelisagroup.com
 CA License #918165



CHRISTOPHER ROSENDO
 PRESIDENT

(312) 694-3503
chris.rosendo@mbe-erectors.com
 3137 S. 55th CT.
 Cicero, IL. 60804

{Business Card}

{Business Card}

Telephone: _____
 Fax: _____
 E-Mail: _____
 Please print clearly

1269715: State/Lake Loop Elevated Station Pre-Bid Conference Attendee Register

Using Department: Department of Transportation (CDOT)
Procurement Specialist: Luis Bejar, Email: Luis.Bejar@CityofChicago.Org
Specification Number: 1269715
Conference Date: Thursday February 1, 2024
Conference Location: City of Chicago, 2 North LaSalle, 2N Mezzanine Conference Center, Great Fire, Chicago, IL
Conference Time: 10:00 A.M.

Attendee Name: <u>CHRIS ROSENDO</u> Company Name: <u>MBE Erectors</u> Company Address: <u>3137 S. 55TH CT.</u> <u>CICERO, IL. 60804</u> Telephone: <u>312-694-3503</u> Fax: _____ E-Mail: <u>chris.rosendo@mbe-erectors.com</u> <small style="text-align: center;">Please print clearly</small>	{Business Card}
Attendee Name: <u>Ryan Gierz</u> Company Name: <u>Nicholson Construction</u> Company Address: _____ Telephone: <u>773-360-4734</u> Fax: _____ E-Mail: <u>ryan.gierz@nicholsonconstruction.com</u> <small style="text-align: center;">Please print clearly</small>	{Business Card}
Attendee Name: <u>RICK JESCHKE</u> Company Name: <u>WEO</u> Company Address: _____ Telephone: <u>773-755-1611</u> Fax: _____ E-Mail: <u>rjeschke@weoneil.com</u> <small style="text-align: center;">Please print clearly</small>	{Business Card}
Attendee Name: <u>Tony Ricordati</u> Company Name: <u>W.E. O'NEIL</u> Company Address: _____ Telephone: <u>773-755-1611</u> Fax: _____ E-Mail: <u>TRICORDATI@WEONEIL.COM</u> <small style="text-align: center;">Please print clearly</small>	{Business Card}

1269715: State/Lake Loop Elevated Station Pre-Bid Conference Attendee Register

Using Department: Department of Transportation (CDOT)
Procurement Specialist: Luis Bejar, Email: Luis.Bejar@CityofChicago.Org
Specification Number: 1269715
Conference Date: Thursday February 1, 2024
Conference Location: City of Chicago, 2 North LaSalle, 2N Mezzanine Conference Center, Great Fire, Chicago, IL
Conference Time: 10:00 A.M.

Attendee Name: <u>Peter McEwen</u> Company Name: <u>ALDRIDGE</u> _____ Company Address: _____ _____ Telephone: _____ Fax: _____ E-Mail: _____ <p style="text-align: center; font-size: small;">Please print clearly</p>	{Business Card}
Attendee Name: <u>Taylor White</u> Company Name: <u>Kiewit</u> _____ Company Address: _____ _____ Telephone: _____ Fax: _____ E-Mail: _____ <p style="text-align: center; font-size: small;">Please print clearly</p>	{Business Card}
Attendee Name: <u>Sermaine Jennings</u> Company Name: <u>Atlas Industries</u> _____ Company Address: _____ _____ Telephone: <u>754-248-5164</u> Fax: _____ E-Mail: <u>Sermaine@AtlasIndustriesInc.com</u> <p style="text-align: center; font-size: small;">Please print clearly</p>	{Business Card}
Attendee Name: <u>JASON NOWLAN</u> Company Name: <u>GARTNER</u> <u>PERMASTEELISA NORTH AMERICA</u> Company Address: _____ _____ Telephone: <u>847-927-7944</u> Fax: _____ E-Mail: <u>J.NOWLAN@PERMASTEELISA.COM</u> <p style="text-align: center; font-size: small;">Please print clearly</p>	{Business Card}